

UNIT QTY	UNIT TAG	UNIT/FIXTURE DESCRIPTION	REFERENCE	DIMENSIONS (W x D x H)	UNIT QTY	UNIT TAG	UNIT/FIXTURE DESCRIPTION	REFERENCE	DIMENSIONS (W x D x H)	UNIT QTY	UNIT TAG	UNIT/FIXTURE DESCRIPTION	REFERENCE	DIMENSIONS (W x D x H)
SALES AREA - CASHWRAP/BACKWRAP (U.S.)					SALES AREA - PRESENTATION FIXTURES					NON-SALES AREA - FIXTURES				
1	US-BB	15'-0" BACKWRAP	A/A11.1	156" x 24" x 34"	9	FF-4	3 X 3 TABLE W/ UNDERSTOCK	-	36" x 36" x 33"	1	NS-1	MANAGER'S WORKSTATION	A/A14.2	72" x 30" x 96 3/4"
	US-BB	15'-0" BACKWRAP	A/A11.1	156" x 24" x 34"		FF-4B	SEASONAL CASHWRAP	-	36" x 36" x 33"		NS-2	ADMINISTRATIVE STATION	A/A14.2	48" x 30" x 6'-0"
	US-BB	15'-0" BACKWRAP	A/A11.1	156" x 24" x 34"	9	FF-5	3 X 5 TABLE W/ UNDERSTOCK	-	36" x 60" x 33"	2	NS-3	MARKETING CART	-	20" X 36" X 26"
	CUSTOM	21'-7" BACKWRAP	A/A11.1	259" x 29" x 34"	2	FF-14	SMALL TOWER	-	30" X 30" X 63"	1	NS-4	STOCKING CART	-	36" X 18"
	US-1B	1-REGISTER CASHWRAP	J/A11.1	48" x 37" x 34"	2	FF-15B	MODULAR FIXTURE (3 SHELVES)	-	20" X 20" X 63"		NS-15B	SMALL SAFE	N/A14.2	14" x 14" x 20"
	US-4B	4-REGISTER CASHWRAP	J/A11.1	168" x 37" x 34"	1	FF-18B	SMALL LAUNCH TABLE	-	60" X 36" X 34"	1	NS-13B	LARGE SAFE	N/A14.2	20" x 20" x 27"
	US-5B	5-REGISTER CASHWRAP	J/A11.1	222" x 37" x 34"	1	FF-18B	LARGE LAUNCH TABLE	-	84" X 36" X 34"	1	NS-14	COAT HOOK	L/A14.2	(6) @ 2" x 5"
	US-6B	6-REGISTER CASHWRAP CONDENSED	J/A11.1	154" x 37" x 34"	2	FF-20	H.D. MUSEUM CUBE	-	18" x 18" x 54"		NS-15B	MICROWAVE / REFRIGERATOR (5H)	C/A14.2	
	US-6B	6-REGISTER CASHWRAP CONDENSED	J/A11.1	164" x 37" x 34"		FF-21B	MARKETING FRAME (SMALL)	-	35 1/2" x 4' 1/2" (FRAME)	1	NS-15B	MICROWAVE / REFRIGERATOR (LG.)	C/A14.2	FULL-SIZED
	US-6B	6-REGISTER CASHWRAP CONDENSED	J/A11.1	222" x 37" x 34"	1	FF-22	MEDIUM TOWER	-	48" X 48" X 56"		NS-15	CABINET	A/A15.1	24" x 12" x 30"
	US-7B	7-REGISTER CASHWRAP CONDENSED	J/A11.1	257" x 37" x 34"	2	FF-23B	IMPULSE FIXTURE	-	30" X 50 X 56"	1	NS-23	LOCKED BACKROOM CONTAINER	A/A14.2	11" X 11" X 16" (BY BRAND)
	FF-1B	1-REG SEASONAL FOB	-	48" x 37" x 34"		FF-23B	MINI IMPULSE FIXTURE	-	30" X 50 X 56"		NS-24	REMOTE PROCESSING DESK	-	48" X 36"
	FF-1B	1-REG SEASONAL FOB	-	48" x 37" x 34"		FF-24	3 X 3 TABLE	-	36" x 36" x 33"		NS-25	BREAK TABLE + CHAIRS	-	30" X 60" (BY BRAND)
1	CUSTOM	8-REG CASHWRAP	A/A11.1	251 3/4" x 37" x 34"		FF-25	3 X 5 TABLE	-	36" x 60" x 33"	1	NS-26	ALL IN ONE	-	
SALES AREA - CASHWRAP/BACKWRAP (INTERNATIONAL)						FF-26	HINGED LED MARKETING FRAME	-	26" X 36" X 33 1/4"	1	NS-27	FOLDING CHAIR RACK	L/A12.1	
	EA-BB	15'-0" BACKWRAP	A/A11.1	156" x 24" x 34"	2	FF-27	PLATFORM (WOOD)	-	26" X 36" X 33 1/4"	3	NS-29	MAGNETIC MARKER BOARD	A/A14.3	36" X 24"
	EA-BB	15'-0" BACKWRAP	A/A11.1	156" x 24" x 34"		FF-28	FEATURE FIXTURE (20H)	-	50" X 50" X 56"		NS-30	MICROWAVE (ADDITIONAL)	-	BY BRAND
	EA-BB	9'-0" BACKWRAP	A/A11.1	114" x 24" x 34"		FF-29	STOREFRONT EASEL	-	TBD	1	NS-31	BREAK BAR	R/A14.2	VARIES (BY G.C.)
	EA-4B	4-REGISTER CASHWRAP	J/A11.1	154" x 37" x 34"		FF-30	15' BACKWRAP GRAPHIC FRAME (LARGE)	A/A11.1	10'-0" X 4'-0" (FRAME)	1	NS-33	CAMERA CABINET (DIGITAL)	S/A14.2	24" X 22" X 24.5"
	EA-5B	5-REGISTER CASHWRAP	J/A11.1	164" x 37" x 34"		FF-31	9'-0" BACKWRAP GRAPHIC FRAME	A/A11.1	8'-2" X 4'-0" (FRAME)	1	NS-34	AUDIO/VISUAL CABINET	S/A14.2	24" X 22" X 24.5"
	EA-6B	6-REGISTER CASHWRAP	J/A11.1	222" x 37" x 34"		FF-32	HINGED LED MARKETING FRAME	-			NS-35	LARGE LOCKER 10' COAT RACK	G/A14.2	48-6" x 16" x 72"
	EA-7B	7-REGISTER CASHWRAP	J/A11.1	257" x 37" x 34"		FF-33	BACKWRAP VIDEO MONITORS (3X3)	A/A11.1	121 1/2" X 9 1/2" X 60 5/8"		NS-36	ELEVATED RECESSED CABINET	A/A15.1	24" X 9 5/8" X 48"
	EA-8B	8-REGISTER CASHWRAP CONDENSED	J/A11.1	168" x 37" x 34"		FF-34	BACKWRAP VIDEO MONITORS (2X2)	-	81" X 9 1/2" X 45 3/4"	4	NS-37	BAR STOOL	-	18 1/2" X 18" X 41"
	EA-9B	9-REGISTER CASHWRAP CONDENSED	J/A11.1	180" x 37" x 34"		FF-35	GUARANTEE MARKETING FRAME	-	52 1/8" X 50" (FRAME)	2	NS-38	FULL LOCKERS	G/A14.2	12 1/4" X 18" X 72"
	EA-10B	6-REG CASHWRAP CONDENSED	J/A11.1	201" x 37" x 34"		FF-36B	FRAGRANCE BAR (SHORT)	-	72" X 20" X 54 3/4"	2	NS-39B	PERSONAL LOCKERS	G/A14.2	8 1/4" X 18" X 72"
	EA-10B	6-REG CASHWRAP CONDENSED	J/A11.1	223" x 37" x 34"		FF-36B	FRAGRANCE BAR (LONG)	-	96" X 20" X 54 3/4"	1	NS-40	SLAT WALL	-	48" x 3/4" x 96" (PER SHEET)
	EA-10B	6-REG CASHWRAP CONDENSED	J/A11.1	257" x 37" x 34"		FF-37	HOME FRAGRANCE BAR	-	48" X 61" X 48"					
	EA-10B	6-REG CASHWRAP CONDENSED	J/A11.1	257" x 37" x 34"		FF-38	EASEL (INTERNATIONAL)	-	26" x 14" x 80"					
	EA-10B	6-REG CASHWRAP CONDENSED	J/A11.1	257" x 37" x 34"	2	FF-40	GONDOLA	-	34" X 72" X 61"					
	EA-10B	6-REG CASHWRAP CONDENSED	J/A11.1	257" x 37" x 34"		FF-41	LONG GONDOLA	-	34" X 109" X 61"					
	EA-10B	6-REG CASHWRAP CONDENSED	J/A11.1	257" x 37" x 34"		FF-42	NARROW GONDOLA	-	27" X 70 1/2" X 61 1/2"					
	EA-10B	6-REG CASHWRAP CONDENSED	J/A11.1	257" x 37" x 34"		FF-43	OVAL IMPULSE FIXTURE	-	56" X 52" X 56"					
	EA-10B	6-REG CASHWRAP CONDENSED	J/A11.1	257" x 37" x 34"		FF-44	STORAGE CABINET	J/A15.1	CUSTOM					
	EA-10B	6-REG CASHWRAP CONDENSED	J/A11.1	257" x 37" x 34"	1	LB-1R	TALL/WIDE LIGHTBOX - RIGHT	-	47 1/4" X 4' X 101"					
	EA-10B	6-REG CASHWRAP CONDENSED	J/A11.1	257" x 37" x 34"	1	LB-1L	TALL/WIDE LIGHTBOX - LEFT	-	47 1/4" X 4' X 101"					
	EA-10B	6-REG CASHWRAP CONDENSED	J/A11.1	257" x 37" x 34"		LB-2R	TALL/NARROW LIGHTBOX - RIGHT	-	34" X 4" X 101"					
	EA-10B	6-REG CASHWRAP CONDENSED	J/A11.1	257" x 37" x 34"		LB-2L	TALL/NARROW LIGHTBOX - LEFT	-	34" X 4" X 101"					
	EA-10B	6-REG CASHWRAP CONDENSED	J/A11.1	257" x 37" x 34"		LB-3R	SHORT/WIDE LIGHTBOX - RIGHT	-	47 1/4" X 4" X 90 1/4"					
	EA-10B	6-REG CASHWRAP CONDENSED	J/A11.1	257" x 37" x 34"		LB-3L	SHORT/WIDE LIGHTBOX - LEFT	-	47 1/4" X 4" X 90 1/4"					
	EA-10B	6-REG CASHWRAP CONDENSED	J/A11.1	257" x 37" x 34"		LB-4R	SHORT/NARROW LIGHTBOX - RIGHT	-	34" X 4" X 90 1/4"					
	EA-10B	6-REG CASHWRAP CONDENSED	J/A11.1	257" x 37" x 34"		LB-4L	SHORT/NARROW LIGHTBOX - LEFT	-	34" X 4" X 90 1/4"					
	EA-10B	6-REG CASHWRAP CONDENSED	J/A11.1	257" x 37" x 34"		LB-5	SMALL STOREFRONT POSTER BOX	-	26" X 4" X 28"					

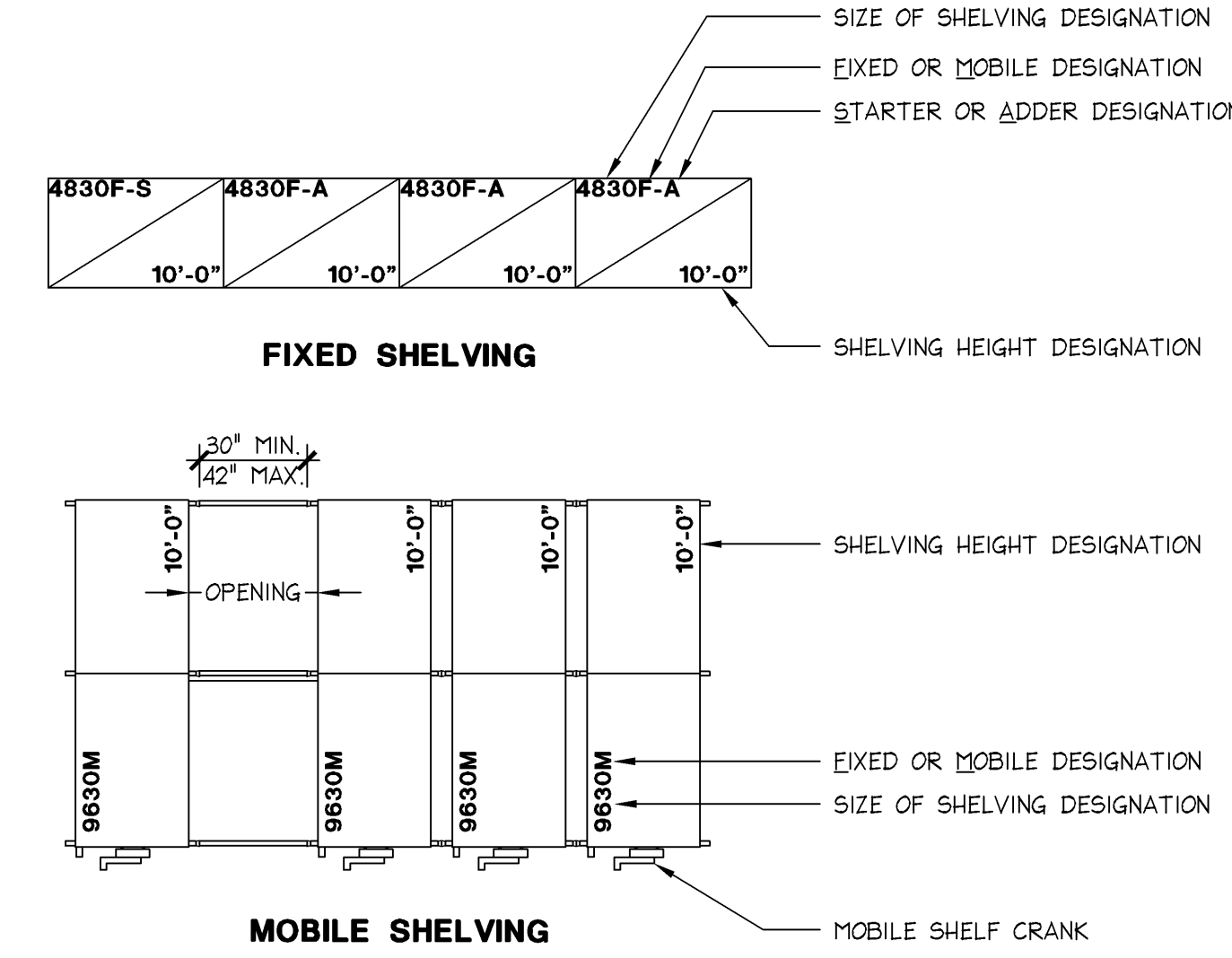

SHELVING LEGEND	1/4" = 1'-0"	H
42L-A061-H00-NOTE		02.17.10

- GENERAL CONTRACTOR IS RESPONSIBLE TO RECEIVE, UNPACK, ASSEMBLE AND SET ACCORDING TO THE FIXTURE PLAN ALL OWNER-FURNISHED DISPLAY FIXTURES AND PRESENTATION ITEMS. G.C. TO DISPOSE OF ALL PACKING MATERIALS ACCORDINGLY.
- UPON COMPLETION OF CABINET INSTALLATION, GENERAL CONTRACTOR TO INSPECT EVERY CABINET TO ENSURE THAT EACH DOOR HANGS PLUMB AND TRUE, AND AT THE SAME TIME RE-TIGHTEN ALL HINGES. (FLOOR FIXTURES, PERIMETER CABINET, CASHWRAP AND BACKWRAP)
- G.C. TO INSPECT ALL DRAWERS & HARDWARE TO ENSURE PROPER OPERATION
- G.C. TO INSPECT ALL FLOOR FIXTURE HARDWARE TO ENSURE THAT EACH DOOR AND DRAWER IS PLUMB AND TRUE, AND AT THE SAME TIME RE-TIGHTEN ALL HINGES.

PRESENTATION / FIXTURE SCHEDULE	FULL	N	PRESENTATION / FIXTURE SCHEDULE CONT'D	FULL	M	PRESENTATION / FIXTURE SCHEDULE CONT'D	FULL	L	PRESENTATION PLAN NOTES	FULL	D
42S-A061-N00-SCDL	10.14.11		42S-A061-N00-SCDL	10.14.11		42S-A061-N00-SCDL	10.14.11		42S-A061-N00-SCDL	02.17.10	

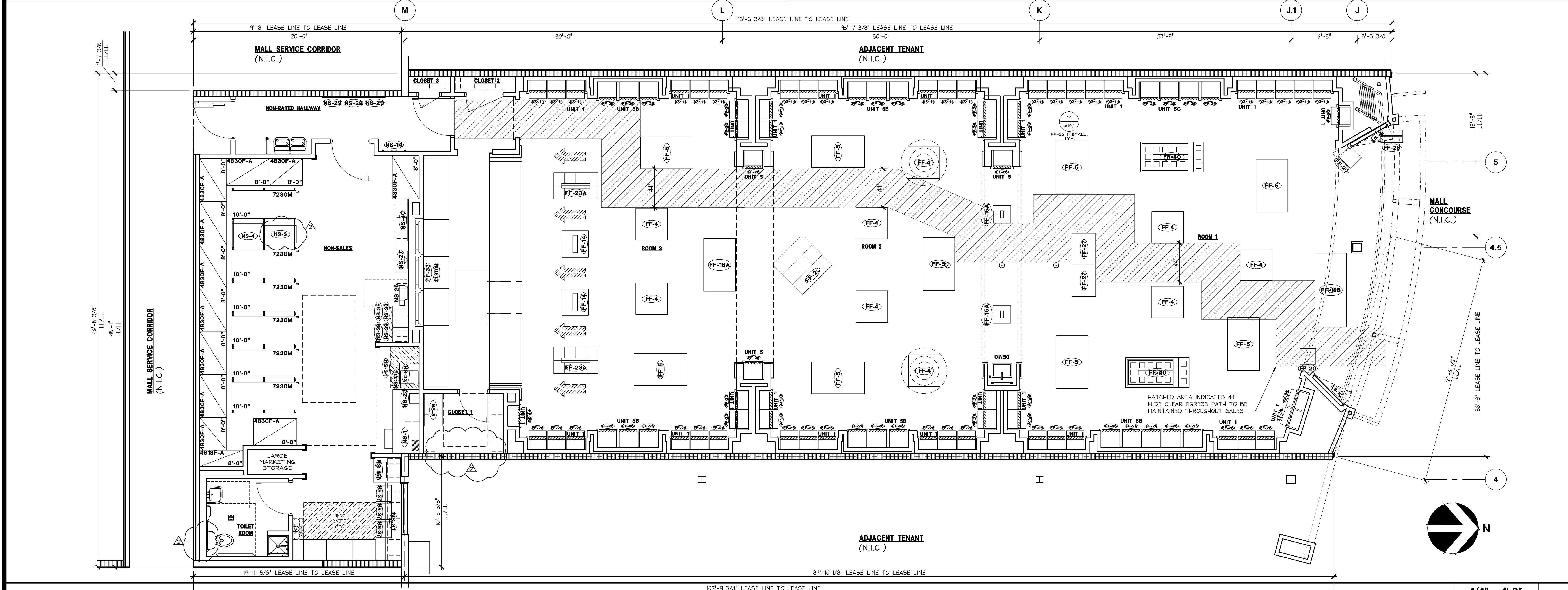

PRESENTATION PLAN	1/4" = 1'-0"	A
42P-A061-A00-PLAN		10.14.11

MOODY-NOLAN
responsive architecture
300 Spruce Street
Suite 300
Columbus, Ohio 43215
Phone: (614) 461-4664
Fax: (614) 280-8881
www.moody-nolan.com

Limited brands
LIMITED STORE PLANNING, INC.
d/b/a STORE DESIGN & CONSTRUCTION
Three Limited Parkway • Columbus, Ohio 43230
Telephone: 614.415.7000 • Fax: 614.415.7349

024200396
BATH & BODY WORKS
MEMORIAL CITY MALL
303 MEMORIAL CITY WAY
HOUSTON, TX 77024
SCOPE: RELO DOWN / NEW PACKAGE:
DESIGN TYPE: EASTON-G GENERATION:
LSDMC PROJECT #: 60685 A/E PROJECT #:

REVISIONS:
REVISION 1 - LL / PLUMB COMMENTS
REVISION 2 - LL / PLUMB COMMENTS
DATE: 6/10/2014
DATE: 6/27/2014
ELITE CONSTRUCTION GROUP
LAKE JACKSON, TX
PHONE: 979-285-0712
NOTE: THESE PRINTS HAVE BEEN
REPRODUCED BY 50 PERCENT SCALE
WILL BE 50 PERCENT OF WHAT IS
NOTED ON PLANS
DATE ISSUED: 04/11/2014
DESIGNED BY: SF
DRAWN BY: TSG
CHECKED BY: TBD
PRESENTATION PLAN
DRAWING NUMBER:
A06.1